

ALLDAY
& MILLER



Helmsdale Close, Hayes, UB4 9QS
£315,000

 2  1  1  D



Helmsdale Close, Hayes, UB4 9QS

£315,000

- Two Double Bedrooms
- Balcony
- Quiet Location
- Ideal First Time Buy or Investment
- 732 Sq Ft / 68 Sq M
- Split Level Maisonette
- Allocated Parking
- Fantastic Transport Links
- New 150 Years Lease
- No Upper Chain

Description

This spacious property is arranged over two floors and comprises of; bright living room measuring 14'10 x 13'7 that overlooks and provides direct access to the balcony allowing an abundance of natural light to flow through, fitted kitchen and contemporary family bathroom.

To the second floor there are two double bedrooms with recently fitted made to measure wardrobes.

Outside

An allocated parking space is located directly outside the property.

There property has its own private balcony that is accessed off the lounge.

A further benefit is that there is a large outside storage area.

Situation

Helmsdale Close is a quiet residential street situated in a picturesque cul-de-sac. It has an easy access route to Hayes & Harlington Station on the new Queen Elizabeth line which has direct links to Central London and the City. There are also convenient bus links to Greenford & Northolt Stations on the Central Line and Uxbridge Station on the Metropolitan Line. Shopping & Restaurant Hubs such as Ealing, Uxbridge and Ruislip are also a short distance away. There are also excellent road links for commuters with the M4 and A40 nearby. The property is located near an Outstanding Nursery and there are multiple local schools and parks.



Floor Plans

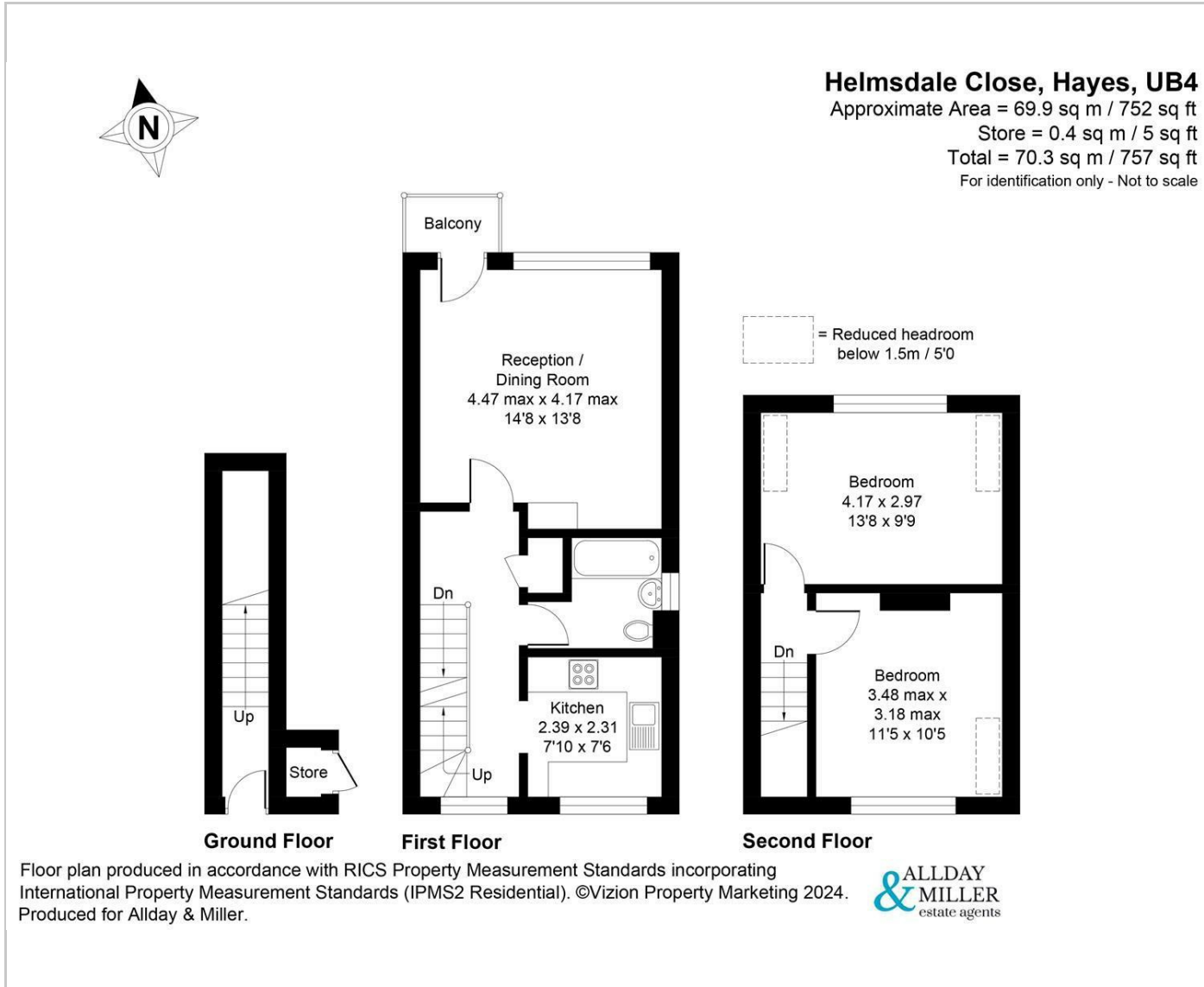

Area Map

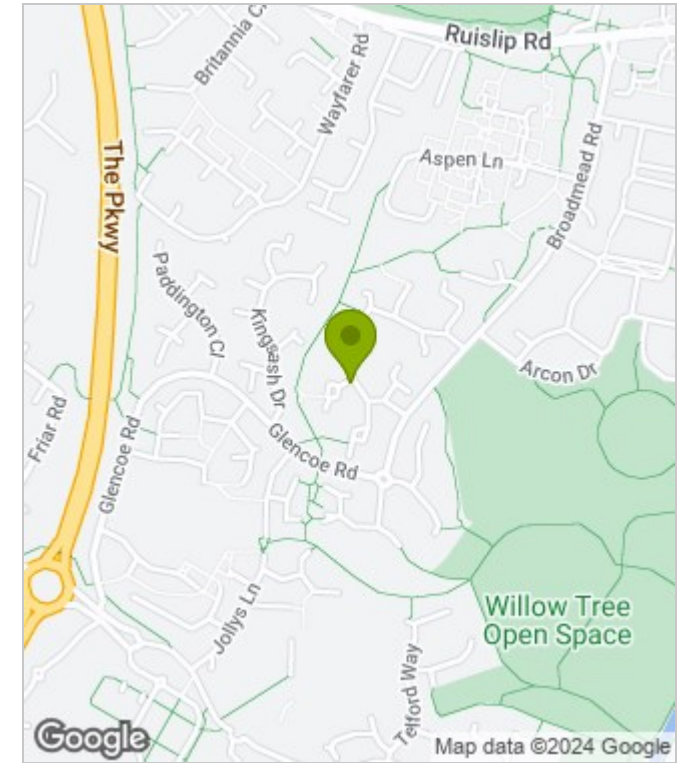

Energy Performance Graph

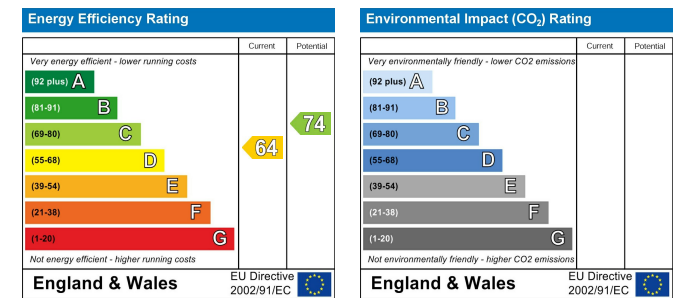

These particulars, whilst believed to be accurate are set out as a general outline only for guidance and do not constitute any part of an offer or contract. Intending purchasers should not rely on them as statements of representation of fact, but must satisfy themselves by inspection or otherwise as to their accuracy. No person in this firm's employment has the authority to make or give any representation or warranty in respect of the property.